

Quite Imposing Trim & Shift (Same Size)

1. Select Trim & Shift, Create New Document, Entire document.

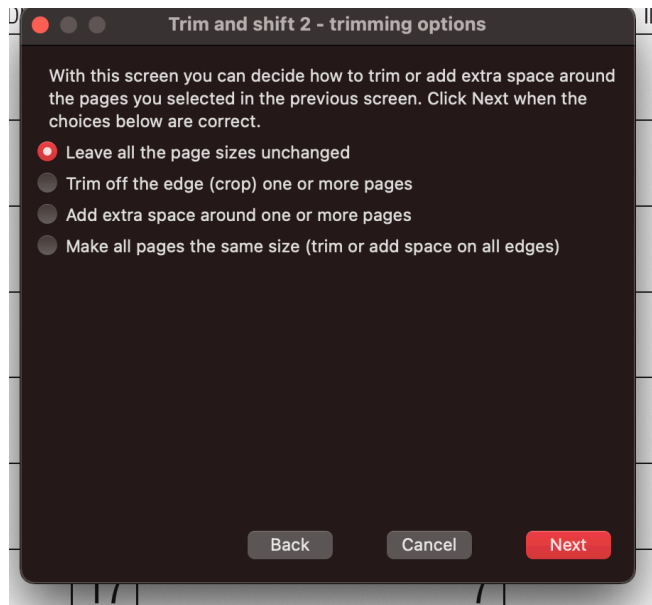
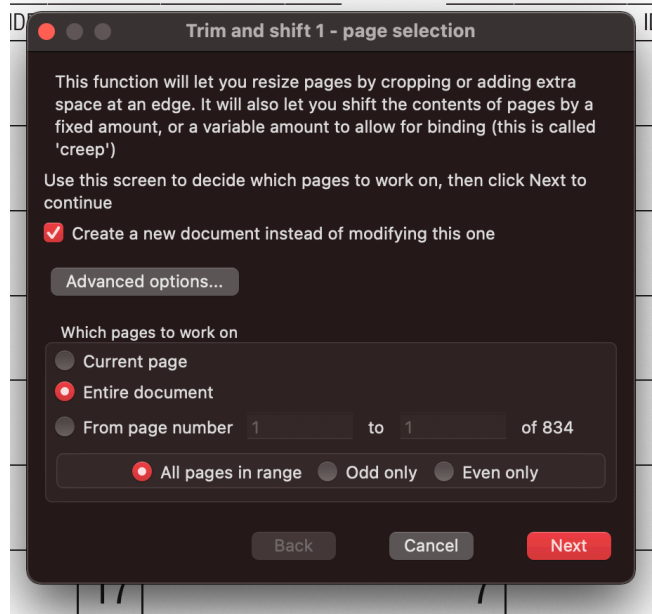

2. Check the leave all the pages the size unchanged. (This is for not changing the size, for just adjusting the placement)

3. Check shift the contents of each selected page by a fixed amount. (Choose the direction and size) In this case, I needed it to go up .50 inches.

